

# LennoxCloud

Multi-site & multi-unit connectivity solution



- # **Convenience** through remote monitoring: the units' performance data is accessible from the comfort of the office.
- # 24/7 monitoring ensures the units' **reliability** and provides building operators with **peace of mind**.
- # The units' performance optimisation leads to **reduced energy consumption and operating costs**.
- # Evaluate **savings on each maintenance procedure** by using real time collected data.
- # **Ensure comfort** in any season with automatic management of CO<sub>2</sub> levels<sup>(1)</sup> and humidity<sup>(2)</sup>.



## USER-FRIENDLY DASHBOARDS

- # The **SITE DASHBOARD** gives a complete overview of the site, presenting monthly or yearly performances, alarm history and energy consumption<sup>(3)</sup> of all installed units.
- # The **UNIT DASHBOARD** allows an overview of a single unit, presenting graphs with the history of indoor and outdoor temperature variations, CO<sub>2</sub> level<sup>(1)</sup> and relative humidity<sup>(2)</sup> in the supply air stream and energy consumption<sup>(3)</sup> for a specific period.

## EXPERT ANALYSIS

- # Thanks to the analysis of the collected data, the Lennox experts will provide the end-users with quarterly reports and recommendations on how to optimise the system's performance and energy consumption<sup>(3)</sup>.

eComfort R32

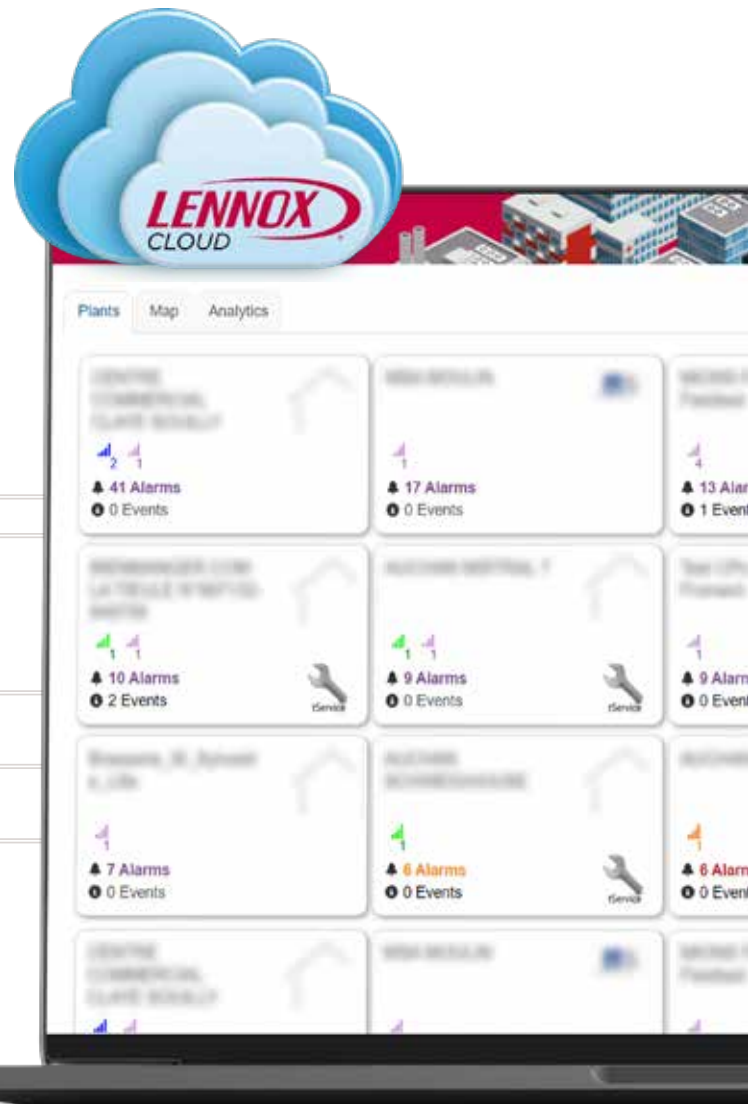

(1) Require Air Quality Sensor (CO<sub>2</sub>) - optional feature on rooftops.  
 (2) Require Humidity Control Pack - optional feature on rooftops.  
 (3) Require Electric Energy Meter - optional feature on rooftops, chillers and heat pumps.

## EASY MONITORING & CONTROL

Specifically designed for end-users, the **eDisplay** allows:

- # Remote access from any web browser.
- # Intuitive adjustment of the system's setpoints:
  - Room temperature.
  - Room temperature set points.
  - Indoor CO<sub>2</sub> levels<sup>(1)</sup>.
  - Indoor humidity levels<sup>(2)</sup>.
  - System ON or OFF button.
  - External temperature.
  - Adjust settings.
  - Adjust time schedule.
  - Fan status.
  - Time schedule status.



LennoxCloud is available as an option on all units.

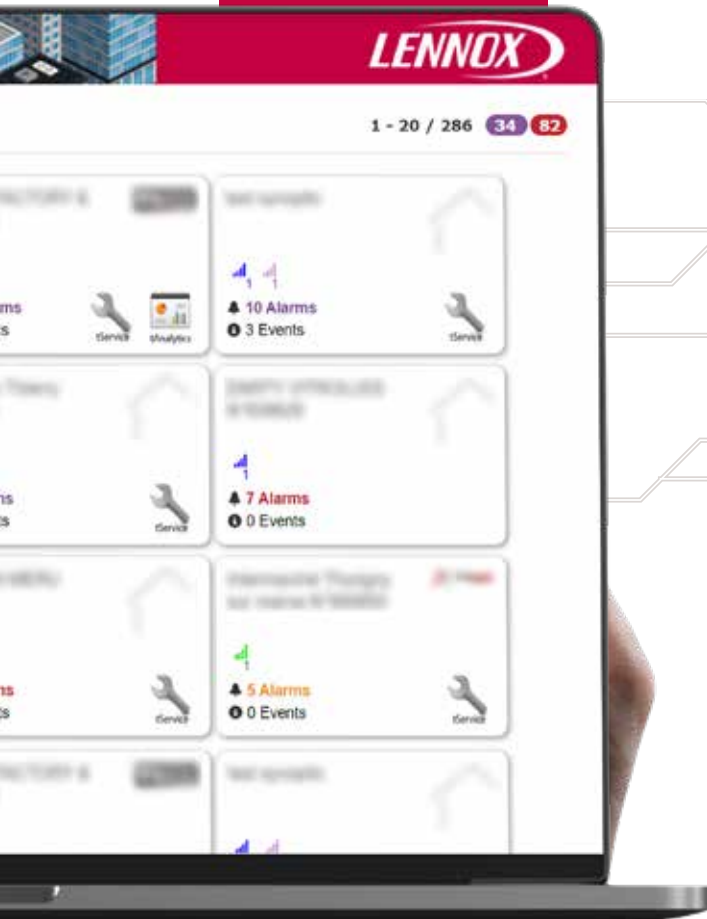

## IMPROVED RESPONSIVENESS

- # The alarm log allows easy identification of critical issues and enables speedy action on them, thus reducing downtime.
- # Email notifications are sent when high level alarms are activated.



e-Baltic



eNeRGy

## EXTENDED UNITS' LIFESPAN

- # The permanent monitoring enables the optimisation of the units' performance and increases their lifespan.